



AKTIV TH

Instruction book

Spare parts

AKTIV
MORGONGÅVA - SWEDEN

PARTS

WAYNE'S FARM EQUIP
502 222 1564

- ①⁶³ ASBLR FOR OUTER SHOE (1) OK ✓
JUL 91 VISA
②⁶⁸ KNIFE HEAD W/ BUSHING (2)
23 AUG 93 C.O.D.

GENERAL

AKTIV TH is a three-point linkage mower which fits all tractors with hydraulic three-point linkage and power take-off shaft of standard type.

The knife is driven through two V-belts which will slip if a solid object enters the cutter bar mechanism causing the jamming of the knife. The pitman and knife are dynamically balanced. This design permits the cutter bar to operate at wide angles of inclination, both up and down. The cutter bar is provided with an overload release which will make it swing back if it hits some solid obstruction.

To ensure satisfactory running of the mower, care must be taken that it is correctly mounted to the tractor and also that it is well lubricated and maintained. Follow the instructions given in this book carefully.

CONTENTS

General	1
Setting up directions	3
Preparation of the tractor	3
Mounting of mower	3
Setting the cutter bar	7
Trial run	10
Transporting position	10
Unhitching the mower	11
Hitching the mower on to the tractor	11
Maintenance instructions	12
General	12
Cutter bar	12
V-belts	13
Replacing knife	13
Overload release	13
Running	14
After mowing	15
Lubrication chart	16
Spare parts list	17
Cutter bar and knife (Normal cut)	19
Cutter bar and knife (Medium cut)	25
Machine frame and driving device	31
Power transmission shaft	39

SETTING UP DIRECTIONS

The mower is delivered in two packages:

1. Case containing frame, drag bar with knife driving device for the knife and grass board.
2. Cutter bar and knives.

Preparation of the tractor

- Check that the hydraulic arms are in their lower position and that the lifting links are applied and fixed to the front holes (applies particularly to tractors with a low hydraulic lifting height).
- Remove the upper link - a special upper link is provided with the mower. The fixing bolt for the upper link already present on the tractor and the locking cotters in the lower links should be used when setting up.
- Determine and mark the position of the hand throttle for 540 rev/min on the power take-off shaft. This is the speed for which the mower is designed.

Mounting of mower

- Place the components where they can be easily seen and remove any paint, etc, that might make mounting difficult. Lubricate bearing points and link connections so that the parts operate freely and easily.
- Position the tractor on a flat and even surface.
- Run the lifting arms of the tractor up to their upper position.
- Measure the distance between the hole in one of the lower links and the floor, dimension A in Fig. 1, and make a note of it.
- Lower the lifting arms level with the power take-off shaft, Fig. 2.

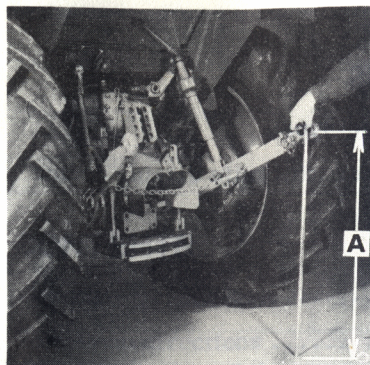

Fig. 1

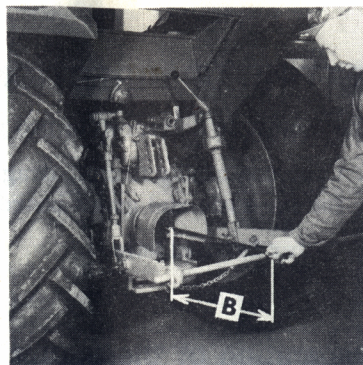

Fig. 2

- Measure the distance between the holes in the lower links and the power take-off shaft, dimension B in Fig. 2, and make a note of it.
- Mount the supporting pins on the frame, cf. Figs. 3 and 4.

if dimension A is less than 75 cm; lower position

if dimension A is 76-84 cm; centre position

if dimension A exceeds 85 cm; upper position

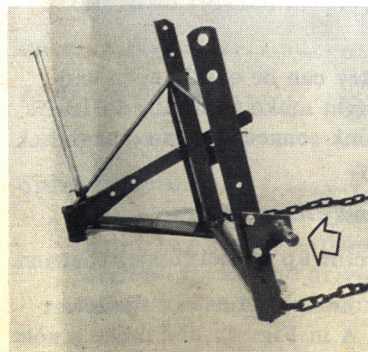

Fig. 3. The supporting pins facing forward in the centre position.

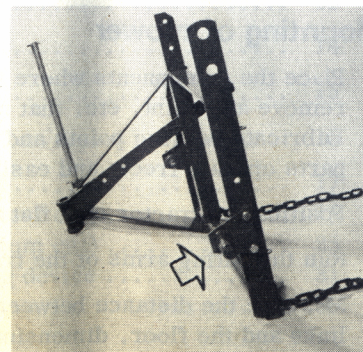

Fig. 4. The supporting pins facing backwards in the centre position.

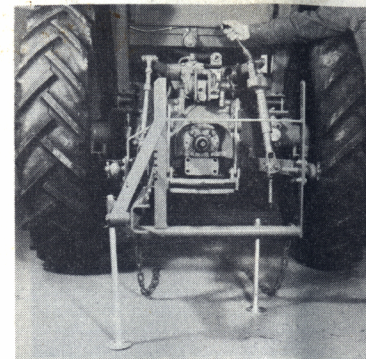

Fig. 5

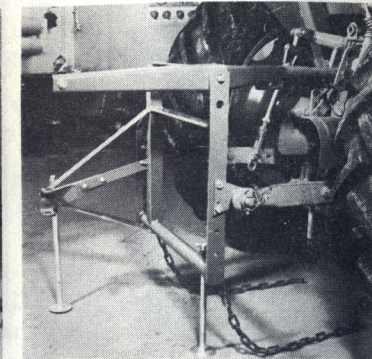

Fig. 6

if dimension B is less than 60 cm; the supporting pin forward

if dimension B is greater than 60 cm; the supporting pin backwards

- Attach the frame, standing on its supporting legs, to the hydraulic arms of the tractor, see Fig. 5. Set the hydraulic arms so that the frame is positioned horizontally.
- Mount the upper link arrangement parallel to the hydraulic arms or slightly upwards towards the tractor, see Fig. 6.

N.B. Insert the bolt as shown in Fig. 7.



Fig. 7

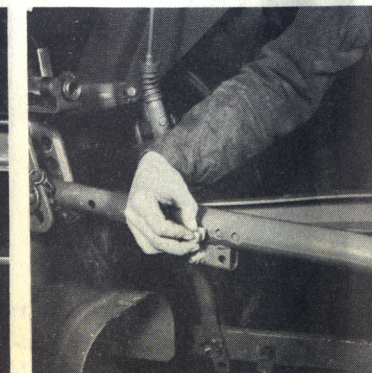

Fig. 8



Fig. 9

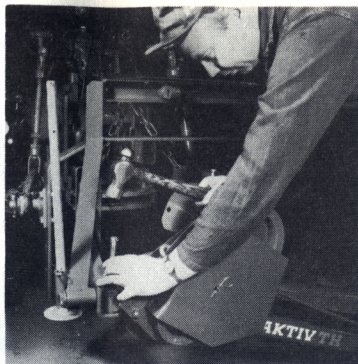

Fig. 10

- Insert the bolt in the upper link in a suitable hole so that the frame is positioned vertically or leans forwards slightly, see Fig. 8.
- Extend the chains and attach them to one of the holes at a suitable link, see Fig. 9. The chains should not be tensioned excessively.
- Raise the supporting legs and lock them with the locking cotters in the upper position, see Fig. 10.
- Attach the body of the mower to the frame, see Fig. 10.

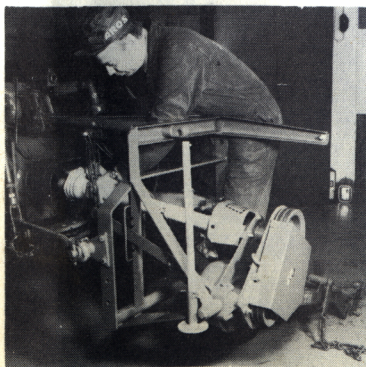

Fig. 11

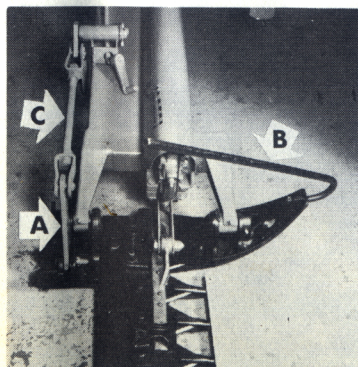

Fig. 12

- Turn the mower body at right angles to the longitudinal direction of the tractor and press the power transmission shaft on to the power take-off shaft, see Fig. 11.
- Insert the knife into the cutter bar. Oil the wearing surfaces and make sure that the knife moves freely.
- Attach the cutter bar to the mower body, see Fig. 12. Attach the lifting link A and the fender rod B to the inner shoe.
- N.B. If the knife head links D, Fig. 13, do not fall over knife head E, this can be corrected using the washers F. In order to do this, unscrew the bolts and remove the swinging arm shaft. Take care to protect the bearing. Place both the washers E on the same side as the knife head link is displaced.

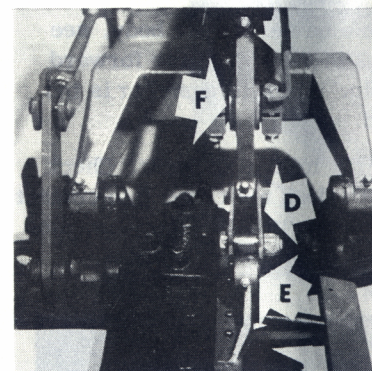

Fig. 13

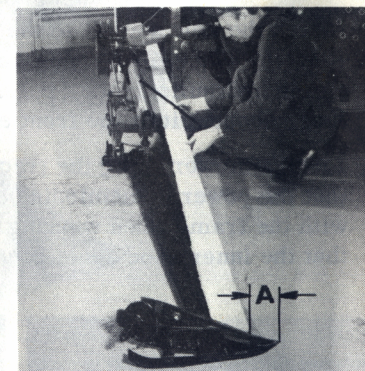

Fig. 14

Setting the cutter bar

- Place a board along the cutter bar, see Fig. 14. When the board lies against the vertical parts of the lifting frame, the point of the outer shoe should lie 80 mm in front of the edge of the board - dimension A, Fig. 14.

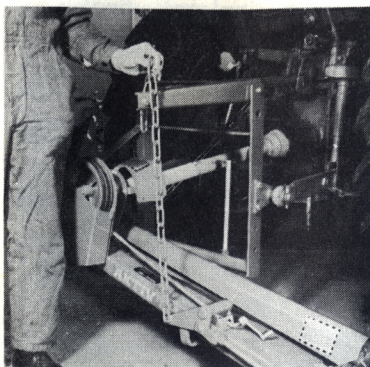

Fig. 15

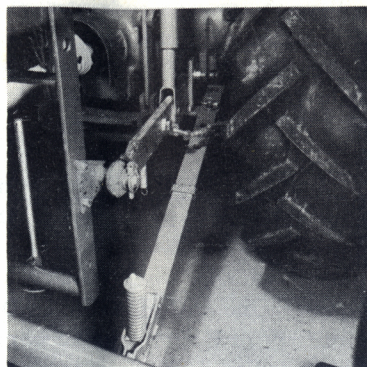

Fig. 16

- Attach the lifting chain to the gag lever. Extend the chain to the bolt hole and then release two links, see Fig. 15.
- Attach the release bar to the hole on the mower body, see Fig. 16. Place the fixing clamps of the bar as far forward on the hydraulic arm as possible. If the release bar is too long, shorten it at the front end.
- Lift the mower using the tractor's hydraulic lever. Check that the power transmission shaft does not come into contact with the frame when working and that it is not too long; also that the inner shoe avoids contact with the rear wheel.

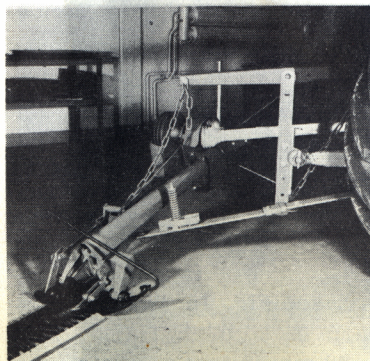

Fig. 17



Fig. 18

- Check the height of the cutter bar above the ground. Adjust the height of the whole bar using the lifting chain. Adjust the height of the outer shoe with link rod C, Fig. 12.
- Lower the cutter bar and pull the release device free. Pull the cutter bar backwards and check that the lifting chain is not tensioned. If this is the case, extend the chain, see Fig. 17. Check that the protective tubes for the power transmission shaft overlap each other by at least 50 mm.
- Attach the stick to the inside of the grass board. Attach the grass board to the outer shoe by means of the swift-hitch device, see Fig. 18.
- Attach the fender rod, see Fig. 19. Bend the rod inwards somewhat.

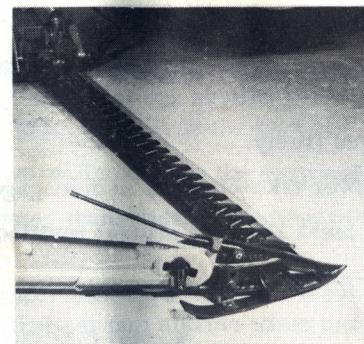

Fig. 19

TRIAL RUN

Make sure

- that the mower is correctly set up.
- that all screws and nuts are securely tightened, especially the two screws through the swinging arm and the screw through the knife head bushing.
- that the machine is lubricated in accordance with the lubrication chart.
- that the V-belts are suitably tight.
- that the protective covers over the power transmission shaft and the V-belt pulleys are in place.
- that the knife moves freely.
- that the tractor power take-off shaft is disengaged.
- that the hydraulic lever is in the neutral position.

Start the tractor and let it run at idling speed. Engage the power take-off shaft and make certain that the knife moves freely. Gradually increase to full speed (power take-off shaft = 540 rev/min).

TRANSPORTING POSITION

Disengage the power take-off shaft. Install the guard cover. Raise the cutter bar into the vertical position and lock it there with the hold-up rod. Raise the mower into its upper position using the hydraulic lift.

N.B. Set the cutter bar in the vertical position by means of the tilt lever.

UNHITCHING THE MOWER

When mowing is finished, or running is discontinued for any length of time, unhitch the mower in the following manner:

- Install the guard cover.
- Lower the cutter bar and put down the front and rear supporting legs so that the mower rests on them.
- Remove the overload release from the bracket on the right-hand hydraulic arm.
- Disengage upper link from the tractor.
- Remove the power transmission shaft from the power take-off shaft (press down the hair pin cotter).
- Remove the lower links from the suspension pins.
- Drive the tractor away.

HITCHING THE MOWER ON TO THE TRACTOR

- Reverse the tractor towards the mower.
- Attach the hydraulic arms to the suspension pins of the frame.
- Press the power transmission shaft on to the power take-off shaft.
- Attach the upper link.
- Attach the overload release.
- Secure the supporting legs in the upper position.

MAINTENANCE INSTRUCTIONS

General

Check regularly that all nuts and bolts are properly tightened - especially the two screws in the swinging arm and the screw through the knife head bushing.

Make sure that all protective shields are in place.

Lubricate the mower in accordance with the lubrication chart on page 16.

Cutter bar

If the mower is to operate satisfactorily, it is important that the cutter bar should be in good condition.

Therefore check regularly:

- that all cutting edges are in line with each other. If necessary, align the guards that have come out of line. Trim blunt and uneven guard tips.
- that the guard ledger plates have sharp edges and that the knife sections are sharp and ground to the proper cutting angle. Replace worn-out guard ledger plates and knife sections.
- that knife back is properly aligned and that all knife sections fit against the guard ledger plates and are properly held down by the clips. The clearance between the knife clips and the knife sections should be just large enough to allow a single sheet of ordinary writing paper to be inserted between clips and sections. The rear and front knife head guides should be fitted tightly so that the knife head does not have too much play. Adjust the position of the wearing plates so that the knife has a good register along its entire length. Replace any worn-out wearing plates. Too much play may cause the knife back to break.
- that the knife moves freely. If the knife seizes up, find the cause and correct in accordance with the above instructions.

V-belts

Check regularly that the V-belts are suitably tight. It should be possible to press them in 10 mm between the belt pulleys, see Fig. 20. Adjust if necessary by moving the stretching pulley.

N.B. When changing belts, change both belts at the same time even if only one is worn out. Make sure that the belts are of the same length so that the tensions are identical.

Replacing knife

- Set the pitman swinging arm as shown in Fig. 12.
 - Remove the screw and the bushing in the knife head.
 - Lift up the outer end of the cutter bar somewhat so that the knife head will move freely under the swinging arm and bring out the knife.
- N.B. Be sure not to lose the knife head bushing.
- Clean and lubricate the new knife, wearing plates and knife head guides.
 - Insert the knife and check that it moves freely without too much play.
 - Attach the knife head bushing and fasten it properly by means of the screw through the knife head link. Lubricate the bushing with the lubricating gun.
 - Check that all screws through the swinging arm are tightened securely.

Overload release

The tension of the overload release spring, Fig. 21, is set at the factory so that the release is actuated by any sudden jerk or snatching motion of the outer end of the cutter bar. If the overload release trips too soon the spring can be retensioned. When setting the overload release, check that the cutter bar is correctly positioned, see Fig. 14.

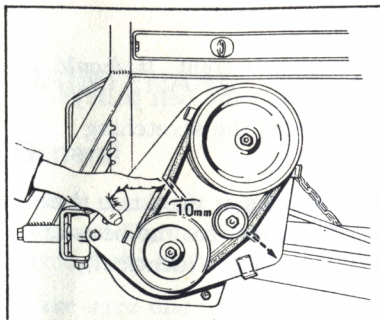

Fig. 20

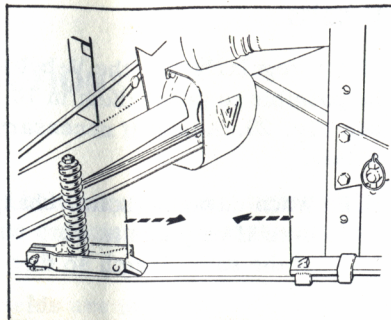

Fig. 21

RUNNING

Check that the power take-off shaft turns at the right speed - 540 rev/min. Raise and lower the cutter bar using the tractor's hydraulic lever. Lower the cutter bar in the unmowed grass only when the knife is in motion.

Engage the knife motion by means of the power take-off shaft engaging lever.

Always disengage the knife motion when work has to be interrupted for some reason.

Adapt the working speed to the condition of the grass. Under favourable conditions a comparatively high speed can be selected, 6-8 km/h. If stops are caused at the cutter bar the speed should be reduced.

Set the guard tips with the tilt lever according to the condition of the grass and ground. Do not set the tips deeper than necessary.

Set a suitable stubble height by re-adjusting the soles in the inner and outer shoe.

If the knife should jam because an object has entered the cutter bar mechanism, the V-belts will slip. If this happens, disengage the power take-off shaft immediately and stop the tractor. Loosen the knife carefully taking care not to break it. Check the cutter bar and knife and adjust if necessary. If the knife has stopped simply because of the thickness of the grass crop, check the V-belt tension.

If the mower is driven into a solid obstruction or if the resistance has become too great, the overload release pawl will open up and the cutter bar will swing backwards. In such circumstances stop the tractor immediately. Restore the cutter bar to its mowing position by reversing the tractor until the overload release pawl has re-engaged.

AFTER MOWING

Clean the mower thoroughly. Replace worn-out or damaged parts. Lubricate guard tips and blades with rust inhibiting oil. Keep the mower where it will not rust.

SAFETY FIRST

1. Check that all protective shields are in place.
2. See that the power take-off shaft of the tractor has the correct speed and does not exceed 550 rev/min.
3. Stop the machine before adjusting and oiling.
4. When the cutter bar mechanism becomes clogged, disengage knife before cleaning.
5. Keep hand, feet and clothing away from working parts. Keep other persons away.

LUBRICATION CHART

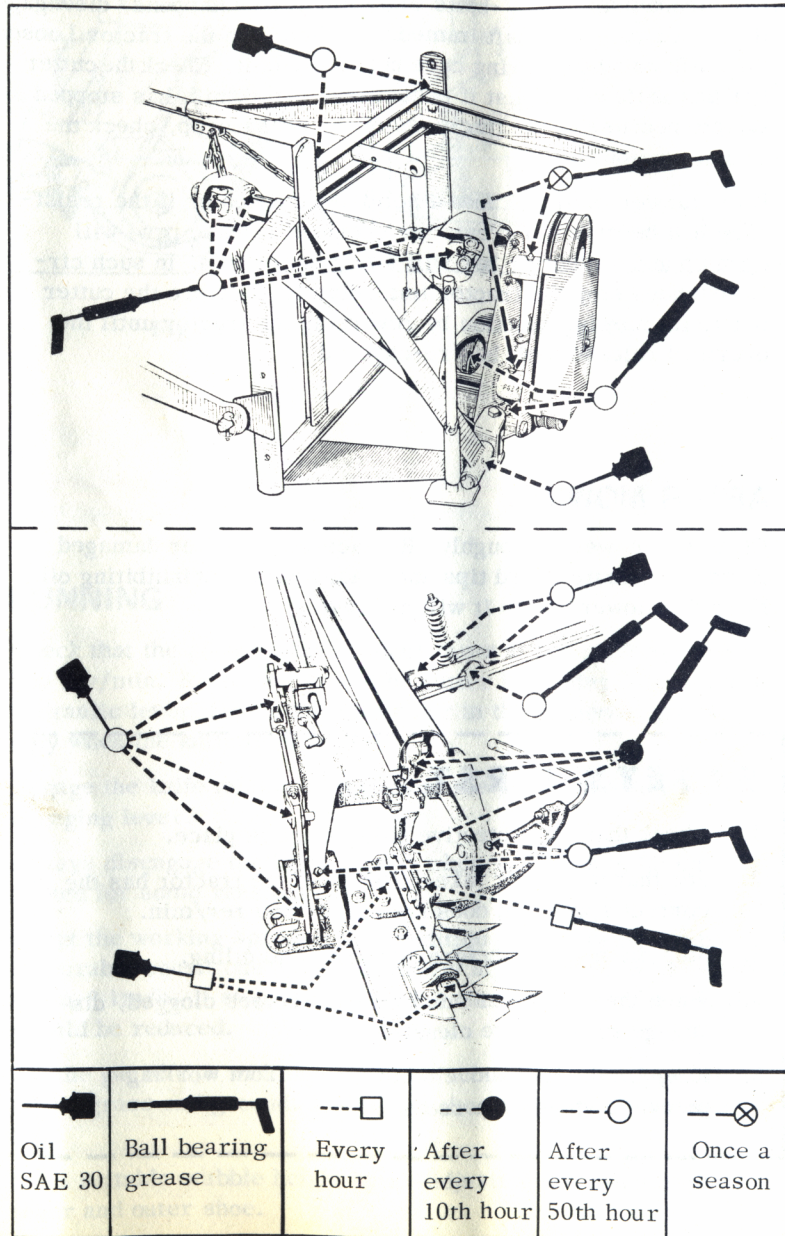

SPARE PARTS LIST

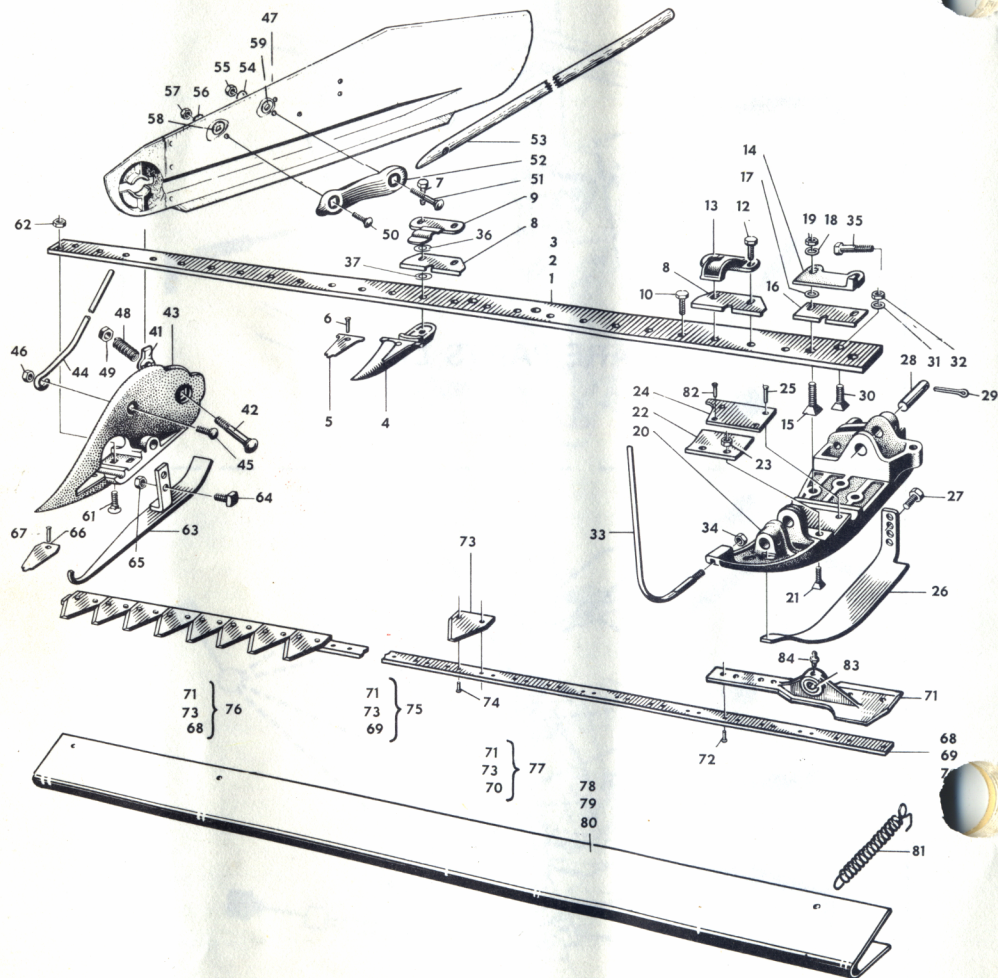

CUTTER BAR AND KNIFE (Normal cut)

Ref. No.	Part No.	Description	No. Pcs.	Dimensions etc.
1	A 367	Guard bar, 5'	1	
2	A 369	Guard bar, 6'	1	
3	9301 224	Guard bar, 7'	1	
4	A 874 B	Guard with ledger plate	19-23-27	
5	A 872	Guard ledger plate, serrated	19-23-27	
6		Rivet	19-23-27	FN 5x26
7		Guard screw	18-22-26	U6S 7/16"x32
8	P 70 A	Wearing plate for knife clip	5-6-7	
9	9301 274	Knife clip	4-5-6	
10		Guard screw	9-11-13	U6S 7/16"x25
12		Guard screw	10-12-14	U6S 7/16"x35
13	A 800	Knife clip	1	
14	A 360 C	Rear knife head guide	1	
15		Screw	2	UFFB 1/2"x60
16	A 349	Wearing plate for rear knife head guide	1	
17	10 90 110	Washer	4	13,5x27,5x0,7
18		Spring washer	2	FBB 1/2"
19		Nut	2	U6M 1/2"UNC
20	P 502 A	Inner shoe	1	
21		Screw	2	FFB 3/8"x35
22	A 361 B	Front knife head guide	1	
23		Nut	2	U6M 3/8"UNC
24	A 8322	Inner shoe ledger plate	1	
25		Rivet	2	FN 5x32
26	A 8306	Sole for inner shoe	1	
27		Screw	1	U6S 1/2"x32
28	A 8803	Inner shoe bolt	2	
29		Split pin	2	SP 6x60
30		Screw	1	FFB 1/2"UNCx40
31		Spring washer	1	FBB 1/2"
32		Nut	1	U6M 1/2"UNC
33	A 9817	Fender rod for inner shoe	1	
34		Nut	1	U6M 3/8"UNC
35		Screw	1	U6S 1/2"UNCx57
36	920 00 926	Adjustment washer	30	
37	930 05 076	Adjustment washer	20	
41	P 539	Holder for outer grass board	1	
42		Screw	1	UVBF 1/2"UNCx102
43	P 263 C	Outer shoe, cpl. with ledger plate	1	

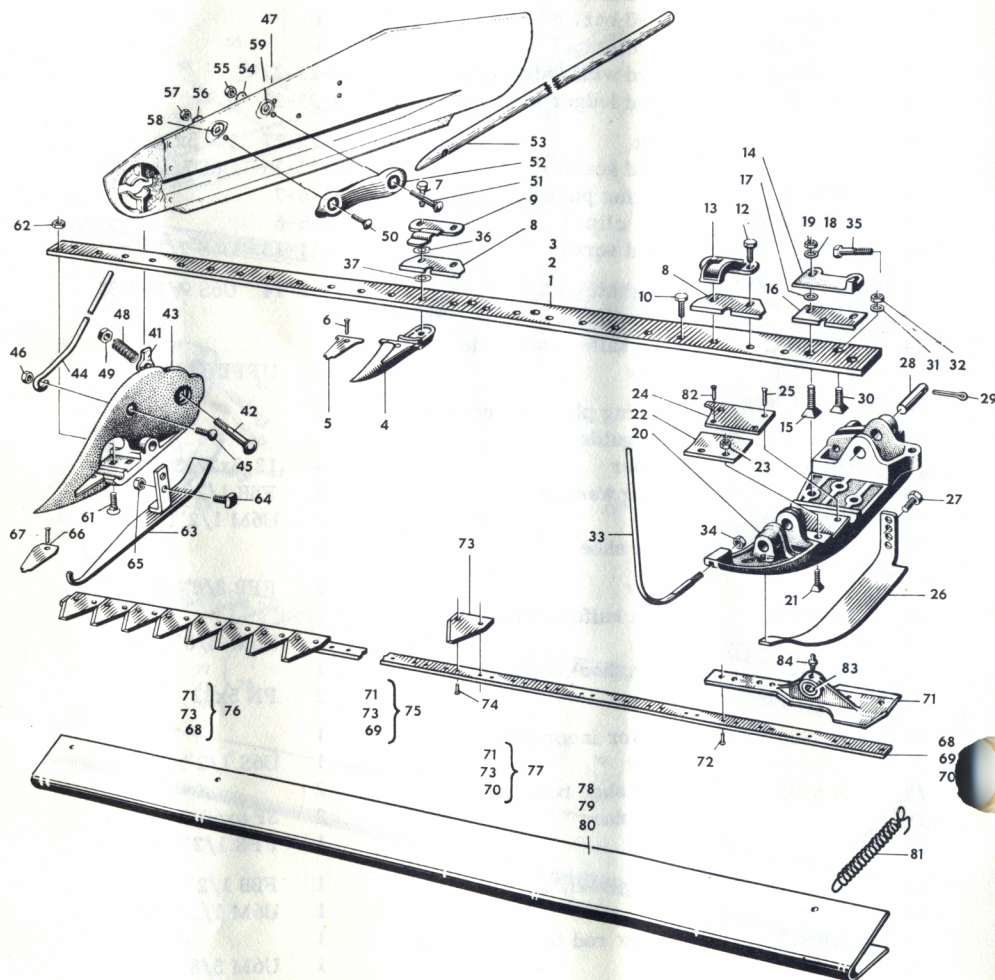

CUTTER BAR AND KNIFE (Normal cut) cont'd

Ref. No.	Part No.	Description	No. Pcs.	Dimensions etc.
44	A 256	Fender rod	1	
45		Screw	1	UVBF 5/16"UNCx25
46		Nut	1	U6M 5/16"UNC
47	P 7362	Grass board, outer	1	
48	W 20043	Spring for outer grass board	1	
49		Nut	1	U6M 1/2"
50		Screw	1	UVBF 5/16"UNCx19
51		Screw	1	UVBF 5/16"UNCx45
52	P 75 A	Grass board stick socket	1	
53	P 273 A	Grass board stick	1	
54		Spring washer	1	FBB 5/16"
55		Nut	1	U6M 5/16"UNC
56		Spring washer	1	FBB 5/16"
57		Nut	1	U6M 5/16"UNC
58	P 1238	Washer	1	9x25x3
59	W 10009	Washer	1	8,5x25x3
61	J 8038	Screw	2	7/16"UNCx33
62		Nut	2	U6M 7/16"UNC
63	A 1016	Sole for outer shoe	1	
64		Screw	1	S4LS 1/2"x30
65		Nut	1	U6M 1/2"UNC
66	P 65	Outer shoe ledger plate	1	
67		Rivet	1	FN 5,3x28
68	P 306	Knife back, 6"	2	
69	P 304	Knife back, 5"	2	
70	P 3058	Knife back, 7"	2	
71	P 7309	Knife head with bushing	2	
72		Rivet	9	KN 5,3x24
73	27 A	Section, plain	20-24-28	
	27 AR	Section, serrated	20-24-28	
74		Rivet	33-41-49	
75	P 7310	Knife with plain sections, cpl., 5'	2	
	P 7322	Knife with serrated sections, cpl., 5'	2	
76	P 7311	Knife with plain sections, cpl., 6'	2	
	P 7323	Knife with serrated sections, cpl., 6'	2	
77	P 7384	Knife with plain sections, cpl., 7'	2	
	P 7383	Knife with serrated sections, cpl., 7'	2	

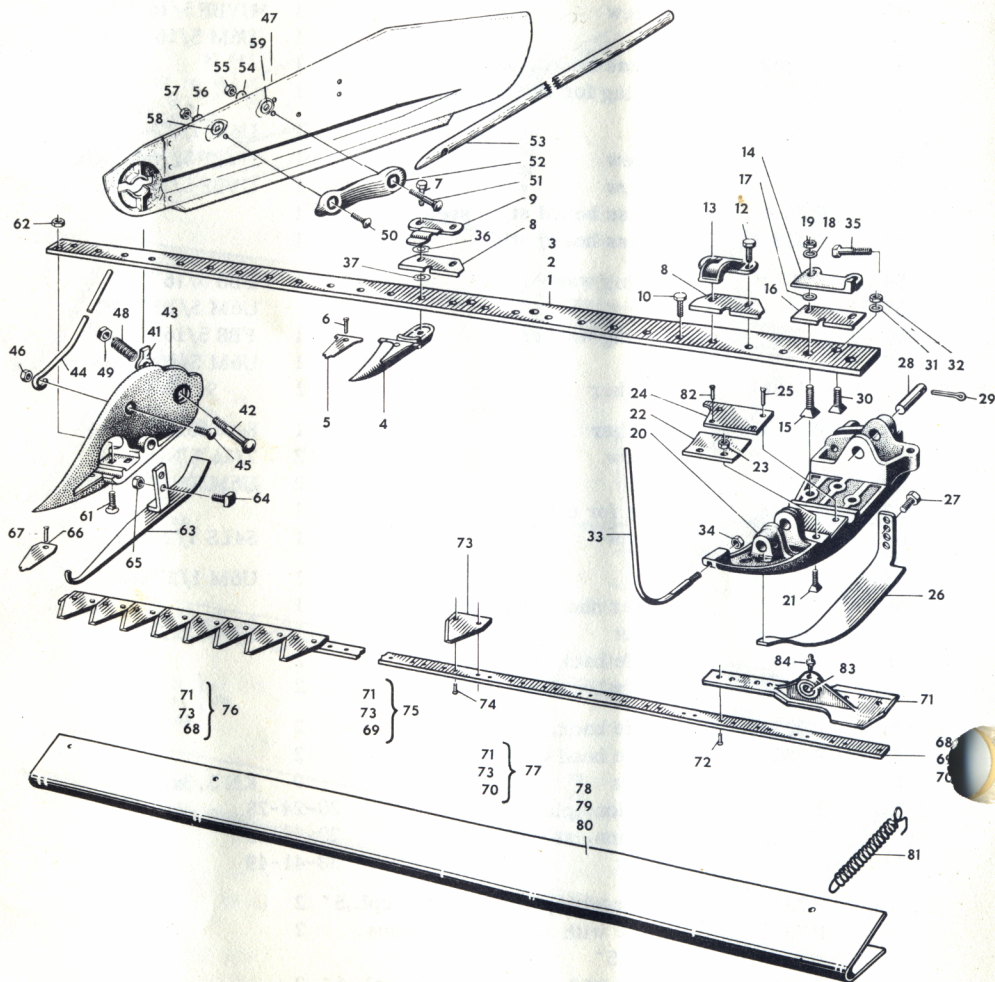

CUTTER BAR AND KNIFE (normal cut) cont'd

Ref. No.	Part No.	Description	No. Pcs.	Dimensions etc.
78	L 5075	Guard cover, 5'	1	
79	L 5076	Guard cover, 6'	1	
80	P 5059	Guard cover, 7'	1	
81	W 20127	Spring for guard cover	2	
82		Rivet	2	FN 5x26
83	P 2045	Bushing for knife head	1	
84		Grease fitting	1	1/4"SAE, straight
	P 7054	Cutter bar, 6', cpl., without knives and grassboards	1	
	P 7094	Cutter bar, 5', cpl., without knives and grassboards	1	
	P 7458	Cutter bar, 7', cpl., without knives and grassboards	1	

Extra equipment

		Screw	1	U6S 1/2"UNCx57
P 7363		Grass board, inner	1	
A 1056		Holder for inner grass board	1	
W 20042		Spring for inner grass board	1	
		Nut	1	U6M 1/2"UNC

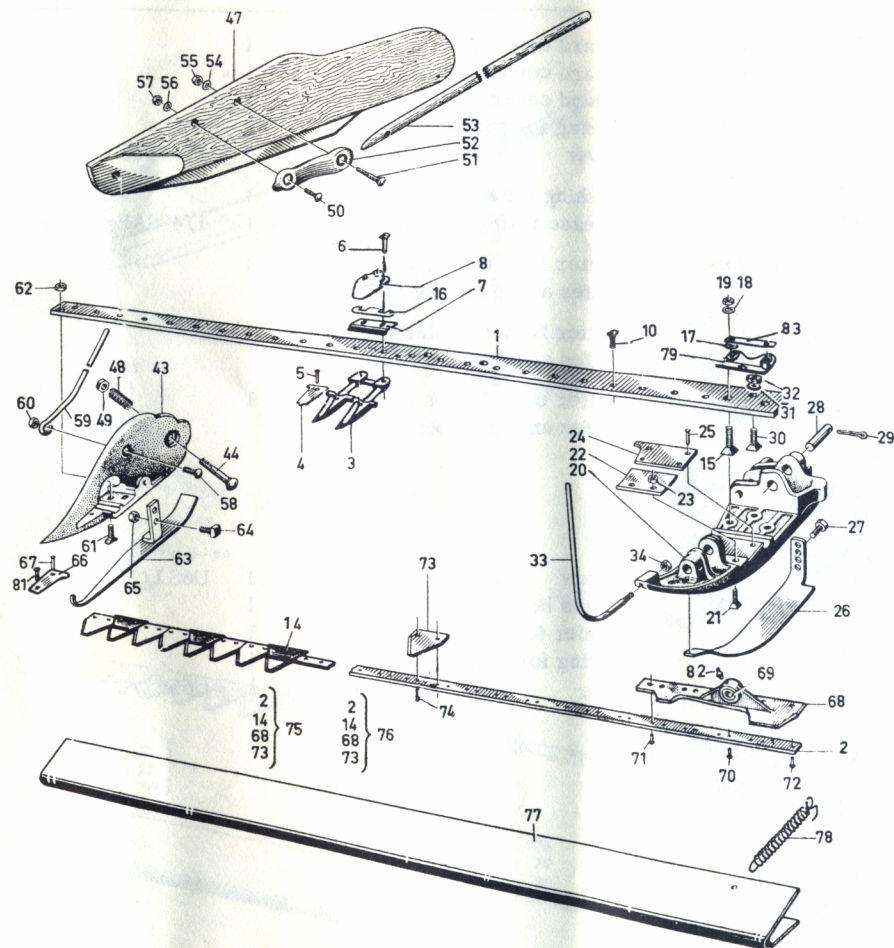

CUTTER BAR AND KNIFE (Medium cut)

Ref. No.	Part No.	Description	No. Pcs.	Dimensions etc.
1	A 632 C	Guard bar, 6'	1	
	A 462 B	Guard bar, 5'	1	
2	A 635	Knife back, 6'	1	
	A 465	Knife back, 5'	1	
3	A 571 B	Guard with ledger plate	15-18	
4	A 572	Ledger plate	29-35	
5		Rivet	29-35	FN 6x26
6		Bolt for A 569 B	5-6	M6S 10x14
7	A 466 C	Wearing plate for knife clip	5-6	
8	A 569 B	Knife clip	5-6	
10		Guard finger bolt	19-23	M6S 10x25
		Guard finger bolt	10-12	M6S 10x35
14	A 570	Wearing pad	5-6	
15		Screw for inner shoe	2	FFB 1/2"x60
16	A 567	Adjusting plate under knife clip	14-18	
17	W 10019	Washer under knife head guide	2	
18		Spring washer	2	FBB 1/2"
19		Nut	2	U6M 1/2"
20	A 8216	Inner shoe, cpl.	1	
21		Screw	2	FFB 3/8"x35
22	A 421 B	Knife head guide, front	1	
23		Nut	2	U6M 3/8"
24	A 8352	Ledger plate for inner shoe	1	
25		Rivet	4	FN 5x26
26	A 8306	Sole for inner shoe	1	
27		Screw	1	U6S 1/2"x32
28	A 8803	Inner shoe bolt	2	
29		Split pin	2	SP 6x60
30		Screw	1	FFB 1/2"x40
31		Spring washer	1	FBB 1/2"
32		Nut	1	U6M 1/2"
33	A 9817	Fender rod for inner shoe	1	
34		Nut	1	U6M 3/8"
43	A 411 C	Outer shoe, cpl., with ledger plate	1	
44		Screw	1	UVBF 1/2"x102
47	A 1010	Grass board, outer	1	
48	W 20043	Spring for outer grass board	1	
49		Nut	1	U6M 1/2"
50		Screw	1	UVBF 5/16"x32

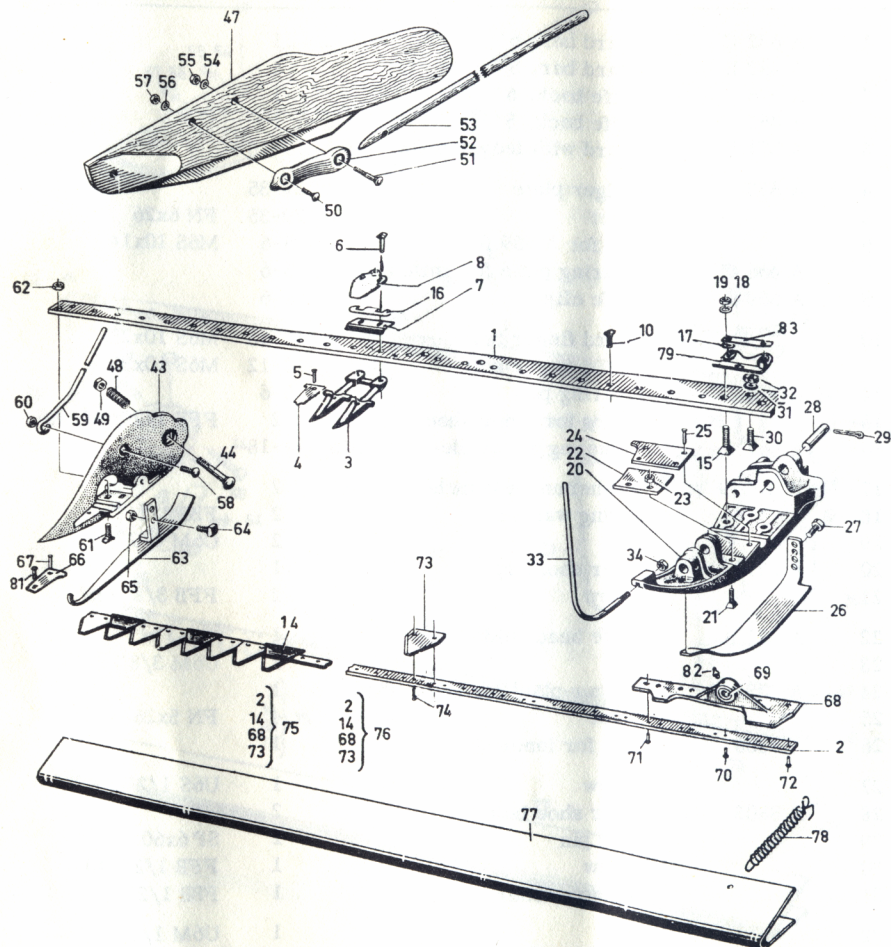

CUTTER BAR AND KNIFE (Medium cut) cont'd

Ref. No.	Part No.	Description	No. Pcs.	Dimensions etc.
51		Screw	1	UVBF 5/16"x64
52	P 75 A	Stick socket on grass board	1	
53	P 273 A	Grass board stick	1	
54		Spring washer	1	FBB 5/16"
55		Nut	1	U6M 5/16"
56		Spring washer	1	FBB 5/16"
57		Nut	1	U6M 5/16"
58		Screw	1	UVBF 5/16"x25
59	A 256	Fender rod for outer shoe	1	
60		Nut	1	U6M 5/16"
61	J 8038	Screw	2	
62		Nut	2	U6M 7/16"
(1) 63	A 1016	Sole for outer shoe	1	
64		Screw	1	S4LS 1/2"x30
65		Nut	1	U6M 1/2"
66	A 444 B	Ledger plate for outer shoe	1	
67		Rivet	2	FN 5x18
(2) 68	P 7327	Knife head with bushing	1	
69	P 2045	Bushing for knife head	1	
70		Rivet	2	LFN 5x25
71		Rivet	4	LFN 5x19
72		Rivet	3	LFN 5x28
73	27 A	Section, plain	20-24	
	27 AR	Section, serrated	20-24	
74		Rivet	33-41	LFN 5x14
75	P 7330	Knife, cpl., 6; plain sections	1	
	P 7331	Knife, cpl., 6; serrated sections	1	
76	P 7328	Knife, cpl., 5; plain sections	1	
	P 7329	Knife, cpl., 5; serrated sections	1	
77	L 5076	Guard cover, 6'	1	
	L 5075	Guard cover, 5'	1	
78	W 20127	Spring for guard cover	2	
79	A 414 C	Knife head guide, rear	1	
81		Rivet	1	LFN 5x15
82	W 15055	Grease fitting	1	
83	A 8348	Washer for rear knife head guide	1	
	A 9928	Cutter bar, cpl., 5; without knives and grassboards	1	
	A 9929	Cutter bar, cpl., 6; without knives and grassboards	1	

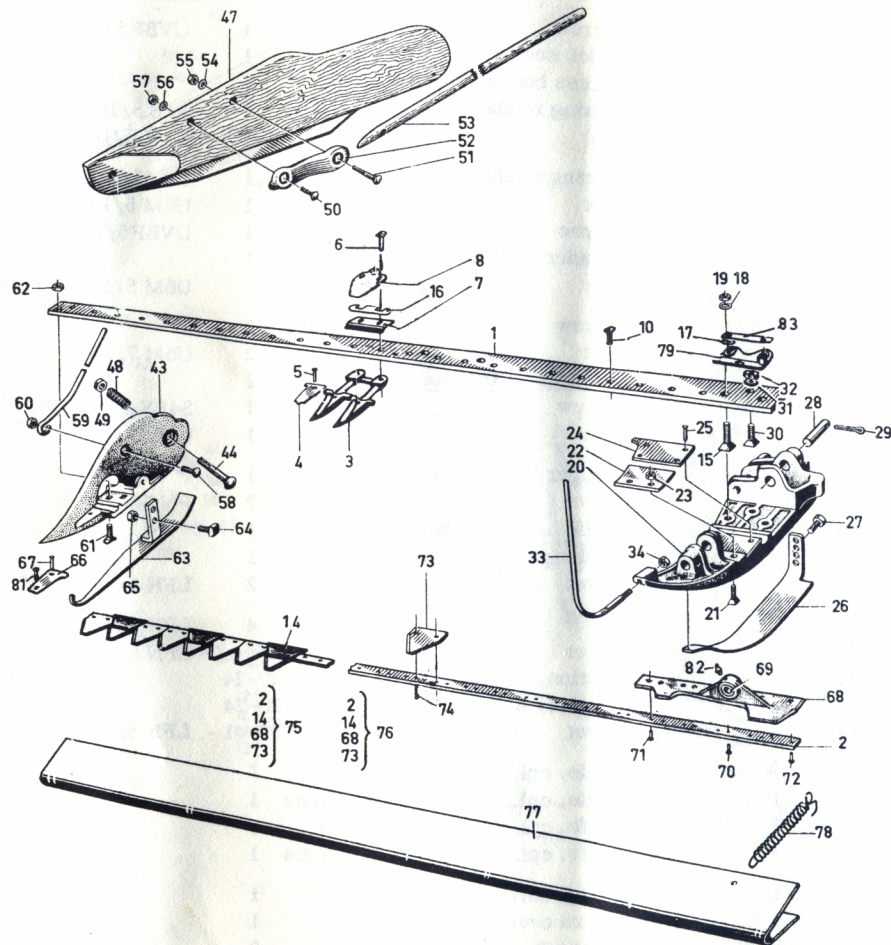

CUTTER BAR AND KNIFE (Medium cut) cont'd

Ref. No.	Part No.	Description	No. Pcs.	Dimensions etc.
<u>Extra equipment</u>				
A 1071		Grassboard, inner	1	
A 1056		Holder for inner grassboard	1	
W 20042		Spring for inner grassboard	1	
		Screw	1	U6S 1/2"x57
		Nut	1	U6M 1/2"

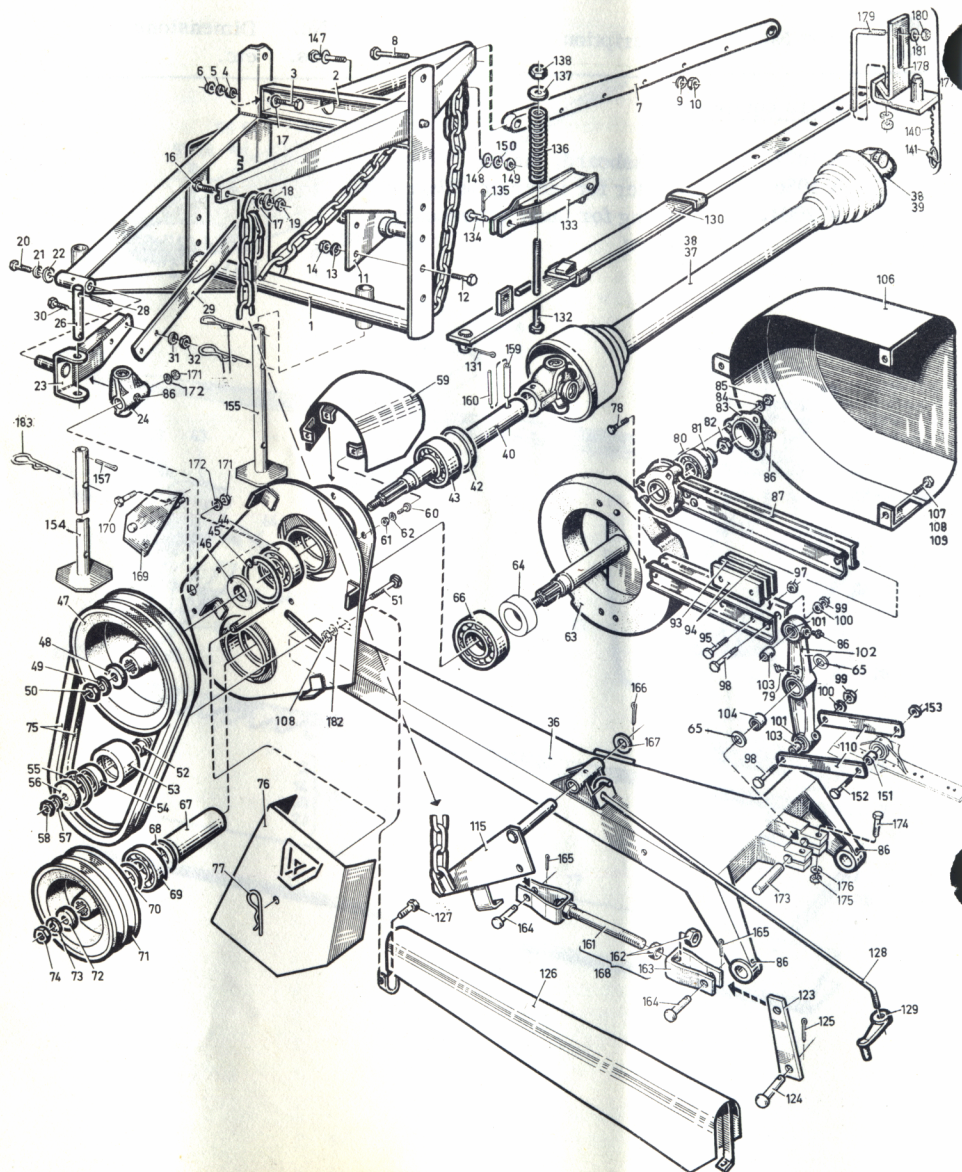

MACHINE FRAME AND DRIVING DEVICE

Ref. No.	Part No.	Description	No. Pcs.	Dimensions etc.
1	P 7263 A	Frame, complete	1	
2	P 7268	Lifting arm, complete	1	
3		Screw	1	U6S 7/16"UNCx32
4	P 6085	Distance tube for cross bar	1	
5		Spring washer	1	FBB 7/16"
6		Nut	1	U6M 7/16"UNC
7	P 7269	Upper link	1	
8		Screw through upper link	1	U6S 1/2"UNCx70
9		Spring washer	1	FBB 1/2"
10		Nut	1	U6M 1/2"UNC
11	P 7266	Anchor plate with suspension pins	2	
12		Screw	4	U6S 1/2"UNCx38
13		Spring washer	4	FBB 1/2"
14		Nut	4	U6M 1/2"UNC
16		Screw for lifting chain	1	U6S 7/16"UNCx32
17	W 10020	Washer	2	SRB 14x28x2
18		Spring washer	1	FBB 7/16"
19		Nut	1	U6M 7/16"UNC
20		Screw for suspension yoke	1	U6S 5/8"UNCx32
21		Spring washer	1	FBB 5/8"
22	W 10030	Washer	1	
23	P 7265	Suspension yoke	1	
24	10 70 508	Suspension joint	1	
26	W 12523	Bearing bolt for suspension joint	1	HCP 20x120
28		Split pin	2	SP 5x30
29	P 7264	Tilt lever	1	
30		Screw for tilt lever	2	U6S 3/8"UNCx25
31		Spring washer	2	FBB 3/8"
32		Nut	2	U6M 3/8"UNC
36	P 7418	Drag bar, complete	1	
37	P 7260 A	Power transmission shaft for 35 mm (1 3/8") shaft	1	Yoke 10.10.00
38	P 7261 A	Power transmission shaft for 28,5 mm (1 1/8") shaft	1	Yoke 10.11.00
40	P 3048	Drive shaft	1	
42		Z-disk	1	Z 206
43	6206	Ball bearing	1	30x62x16
44	6205	Ball bearing	1	25x52x15
45	W 14055	Circlip	1	SgH 52

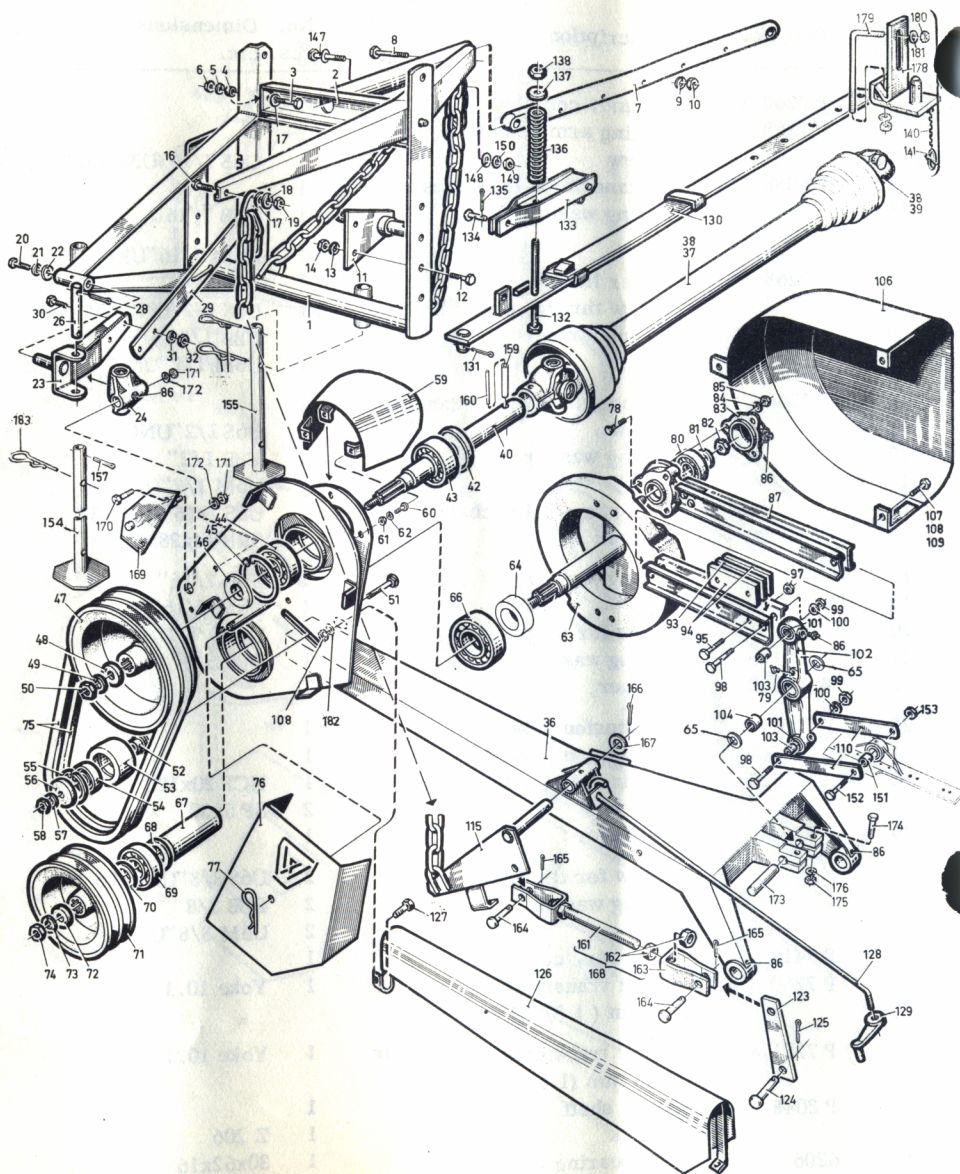

MACHINE FRAME AND DRIVING DEVICE (cont'd)

Ref. No.	Part No.	Description	No. Pcs.	Dimensions etc.
46	10 92 139	Washer for ball bearing	1	25x37x2
47	P 445	V-belt pulley, upper, D=207mm	1	P 450, D=217 mm
48	10 91 127	Washer for V-belt pulley	1	20, 2x40x5
49		Spring washer	1	FBF 3/4"
50		Nut	1	U6M 3/4"UNC
51		Screw for stretching pulley	1	UVBF 1/2"UNCx70
52	P 3057	Bearing seat for stretching pulley	1	
53	P 6091	Stretching pulley	1	
54	6204 2Z	Ball bearing for stretching pulley	1	20x47x14
55	W 14054	Circlip	1	SgH 47
56	P 3052	Washer, outer, for stretching pulley	1	
57		Spring washer	1	FBF 1/2"
58		Nut for stretching pulley	1	U6M 1/2"UNC
59	P 7290	Protecting spout for universal joint	1	
60		Screw for protecting spout	3	U6S5/16"UNCx19
61		Nut	3	U6M 5/16"UNC
62		Spring washer	3	FBF 5/16"
63	P 7293	Crank shaft with counterweight, complete	1	
64	930 06 107	Distance sleeve	1	
65	10 90 122	Washer	1	20, 5x30x1, 5
66	6207 Z	Ball bearing	1	35x72x17
67	P 6090	Distance tube in lower nave	1	
68	10 90 153	Washer	1	30, 5x45x2
69	6206	Ball bearing	1	30x62x16
70	10 90 153	Washer	1	30, 5x45x2
71	P 446	V-belt puller, lower, D=142 mm	1	P451, D=130 mm
72	10 91 127	Washer for V-belt pulley	1	20, 2x40x5
73		Spring washer	1	FBF 3/4"
74		Nut	1	U6M 3/4"UNC
75	B 38	V-belt	2	
76	P 5038	Belt guard	1	
77	W 12600	Locking pin	1	
78		Screw for pitman bearing	3	UVBF 1/4"UNCx32
79		Grease fitting	1	1/8"PTF, 45°
80	6304	Ball bearing	1	20x52x15
81	W 10020	Washer for crank pin	1	SRB 14x28x2
82	A 200	Crank pin nut	1	

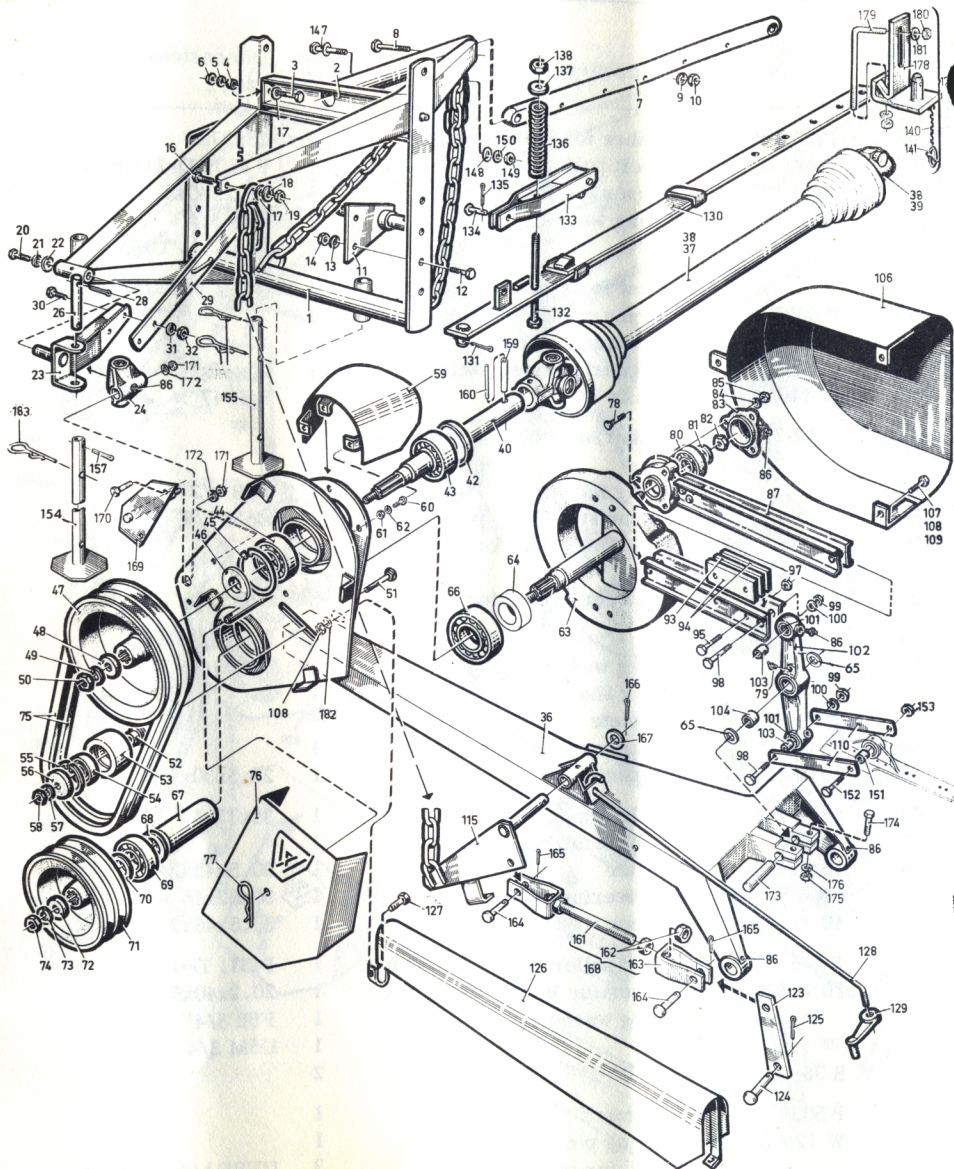

MACHINE FRAME AND DRIVING DEVICE (cont'd)

Ref. No.	Part No.	Description	No. Pcs.	Dimensions etc.
83	A 62 B	Cover for pitman ball bearing	1	
84		Spring washer	3	FBB 1/4"
85		Nut	3	U6M 1/4"UNC
86		Grease fitting	8	1/8"PTF, straight
87	P 7294	Pitman with ball bearing cup, without ball bearing	1	
93	P 1232	Counterweight	1	
94	P 1217	Counterweight	2	
95		Screw for counterweight	2	U6S 5/16"UNCx38
97		Nut	2	U6M 5/16"UNC
98		Screw for swinging arm and crank link	2	U6S 1/2"UNCx45D80
99		Nut	2	U6M 1/2"UNC
100		Spring washer	2	FBB 1/2"
101	P 6098	Needle bearing for swinging arm	2	
102	P 7295	Swinging arm with bushing and needle bearing	1	
103	P 2044	Inner race for needle bearing	2	
104	M 6768	Roller bearing	1	
106	P 7291	Crank wheel cover	1	
107		Screw	2	U6S 5/16"UNCx19
108		Nut	2	U6M 5/16"UNC
109		Spring washer	2	FBB 5/16"
110	P 1222	Knife head link	2	
115	P 7280 A	Lifting lever	1	
123	P 1194	Lever on inner shoe	1	
124	W 11023	Bolt for lever on inner shoe	1	1/2"x42
125		Split pin	1	SP 4x20
126	P 7419	Pitman protecting spout	1	
127		Screw	1	U6S 5/16"UNCx19
128	P 2042	Cutter bar hold-up rod	1	
129	A 8207 B	Handgrip nut	1	
130	P 7277	Overload release	1	
131		Split pin	1	SP 6x30
132		Screw	1	U6S 1/2"UNCx216
133	P 7029	Overload release pawl	1	
134	W 11021	Bolt for overload release	1	1/2"x35
135		Split pin	1	SP 4x20
136	W 20054	Spring	1	
137	P 509	Washer	1	
138		Nut	1	U6M 1/2"UNC

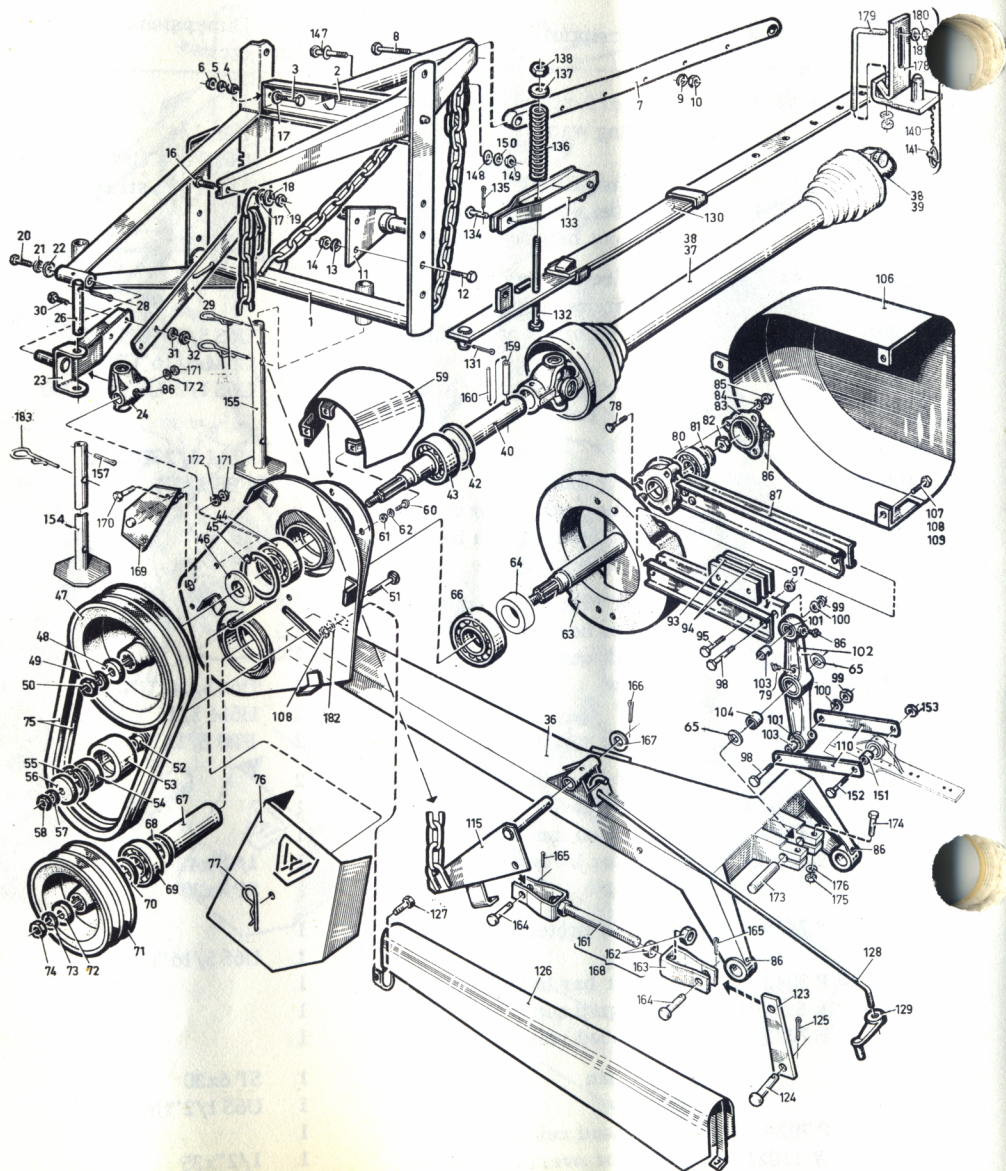

MACHINE FRAME AND DRIVING DEVICE (cont'd)

Ref. No.	Part No.	Description	No. Pcs.	Dimensions etc.
140	P 6096	Chain for locking pin	1	
141	W 12203	Locking pin with ring	1	ø 6 mm
147		Screw for suspension chains	1	U6S 7/16"UNCx64
148		Washer	2	SRB 14x28x2
149		Nut	1	U6M 7/16"UNC
150		Spring washer	1	FBB 7/16"
151	P 2044	Bushing for knife head	1	
152		Screw	1	U6S 1/2"UNCx51D80
153		Locking nut, low	1	Nyloc 1/2"UNC
154	P 7371	Supporting leg, rear	1	
155	P 7372	Supporting leg, front	1	
157		Split pin	1	SP 5x30
159	61.05.00	Tension pin	1	10x45
160	61.03.01	Tension pin	1	6x45
161	P 2050	Lifting link	1	ø 16x256
162		Nut	4	U6M 5/8"
163	A 860	Gag clevis	1	
164	A 98	Bolt in lifting link	2	
165		Split pin	2	SP 4x20
166		Split pin	2	SP 6x40
167		Washer	1	SRB 26x42
168	P 7387	Lifting link, complete	1	
169	P 7388	Axle journal for suspension joint	1	
170		Screw	2	U6S 1/2"UNCx32
171		Nut	3	U6M 1/2"UNC
172		Spring washer	3	FBB 1/2"
173	P 2049	Axle journal for swinging arm	1	
174		Screw	2	U6S 3/8"UNCx57
175		Nut	2	U6M 3/8"UNC
176		Spring washer	2	FBB 3/8"
177	P 7298	Overload release bracket, cpl.	1	
178	P 7279 A	Overload release bracket	1	
179	P 2046 A	Cramp iron	1	
180		Nut	2	U6M 5/8"
181		Washer	2	TBRB 17x34
182		Springing washer	1	FB 5/16"
183	W 12601	Hair pin cotter	3	

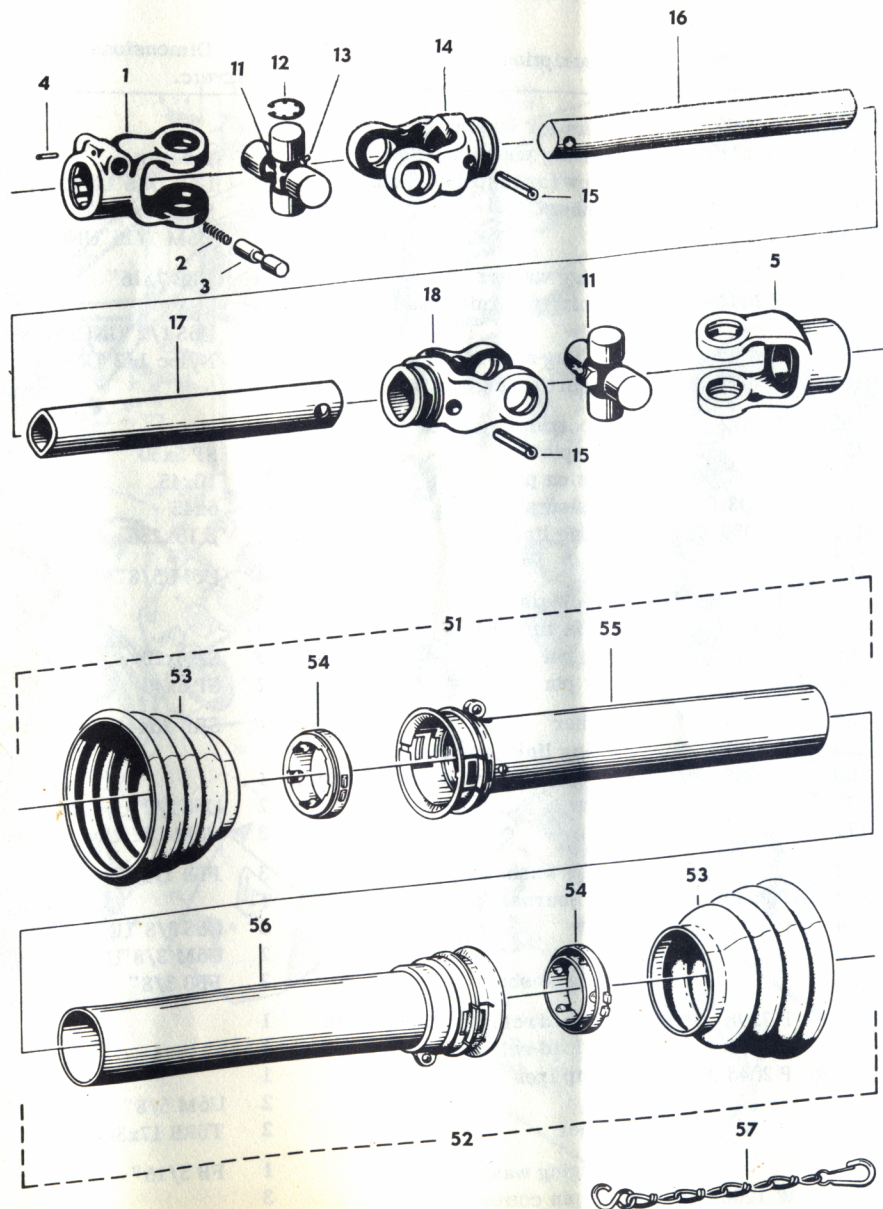

POWER TRANSMISSION SHAFT

Ref. No.	Part No.	Description	No. Pcs.	Dimensions etc.
1	10.10.00	Universal joint yoke with quick hitching for 1 3/8" (35 mm) P.T.O. shaft	1	
	10.11.00	Universal joint yoke with quick hitching for 1 1/8" (28,5 mm) P.T.O. shaft	1	
2	66.01.00	Spring	1	
3	65.01.00	Retaining pin	1	
4	61.02.00	Tension pin	1	4x20
5	10.22.11	Yoke	1	ø 30
11	10.01.00	Universal joint yoke centre, complete kit	2	
12	62.02.00	Lock ring	8	
13	63.22.01	Grease fitting	2	
14	10.48.00	Bearing yoke for inner tube	1	
15	61.04.01	Tension pin	2	8x50
16	75.06.15	Inner tube	1	L = 575 mm
17	75.12.15	Outer tube	1	L = 560 mm
18	10.49.00	Bearing yoke for outer tube	1	
51	83.110	Inner protective tube, complete	1	
52	83.111	Outer protective tube, complete	1	
53	83.05.04	Protection	2	
54	83.08.01	Lock ring with ball bearing	2	
55	80.34.03	Inner protective tube	1	L = 520 mm
56	80.35.03	Outer protective tube	1	L = 520 mm
57	82.36.03	Chain		
	P 7260 A	Power transmission shaft for 1 3/8" (35 mm) shaft, cpl., overall length 665 mm	1	
	P 7261 A	Power transmission shaft for 1 1/8" (28,5 mm) shaft, cpl., overall length 665 mm	1	

NUMERICAL REGISTER

Part No.	Page	Ref. No.	Part No.	Page	Ref. No.	Part No.	Page	Ref. No.
27 A	21	73	A 1016	27	63	P 1217	35	
27 A	27	73	A 1056	23		P 1222	35	110
27 AR	21	73	A 1056	29		P 1232	35	93
27 AR	27	73	A 1071	29		P 1238	21	58
6204 2 Z	33	54	A 8207 B	35	129	P 2042	35	128
6205	31	44	A 8216	25	20	P 2044	35	103
6206	31	43	A 8306	25	26	P 2044	37	151
6206	33	69	A 8306	19	26	P 2045	23	83
6207 Z	33	66	A 8322	19	24	P 2045	27	69
6304	33	80	A 8348	27	83	P 2046 A	37	179
A 62 B	35	83	A 8352	25	24	P 2049	37	173
A 98	37	164	A 8803	25	28	P 2050	37	161
A 200	33	82	A 8803	19	28	P 3048	31	40
A 256	21	44	A 9817	19	33	P 3052	33	56
A 256	27	59	A 9817	25	33	P 3057	33	52
A 349	19	16	A 9928	27	83	P 3058	21	70
A 360 C	19	14	A 9929	27	83	P 5038	33	76
A 361 B	19	22	B 38	33	75	P 5059	23	80
A 367	19	1	J 8038	21	61	P 6085	31	4
A 369	19	2	J 8038	27	61	P 6090	33	67
A 411 C	25	43	L 5075	23	78	P 6091	33	53
A 414 C	27	79	L 5075	27	77	P 6096	37	140
A 421 B	25	22	L 5076	23	79	P 6098	35	101
A 444 B	27	66	L 5076	27	77	P 7029	35	133
A 462 B	25	1	M 6768	35	104	P 7054	23	
A 465	25	2	P 65	21	66	P 7094	23	
A 466 C	25	7	P 70 A	19	8	P 7260 A	31	
A 567	25	16	P 75 A	21	52	P 7261 A	31	
A 569 B	25	8	P 75 A	27	52	P 7263 A	31	
A 570	25	14	P 263 C	19	43	P 7264	31	29
A 571 B	25	3	P 273 A	21	53	P 7265	31	23
A 572	25	4	P 273 A	27	53	P 7266	31	11
A 632 C	25	1	P 304	21	69	P 7268	31	2
A 635	25	2	P 306	21	68	P 7269	31	7
A 800	19	13	P 445	33	47	P 7277	35	130
A 860	37	163	P 446	33	71	P 7279 A	37	178
A 872	19	5	P 502 A	19	20	P 7280 A	35	115
A 874 B	19	4	P 509	35	137	P 7290	33	59
A 1010	25	47	P 539	19	41	P 7291	35	106
A 1016	21	63	P 1194	35	123	P 7293	33	63

Part No.	Page	Ref. No.	Part No.	Page	Ref. No.	Part No.	Page	Ref. No.
P 7294	35	87	W 11023	35	124	75.12.15	39	17
295	35	102	W 12203	37	141	80.34.03	39	55
7298	37	177	W 12523	31	26	80.35.03	39	56
P 7309	21	71	W 12600	33	77	82.36.03	39	57
P 7310	21	75	W 12601	37	183	83.05.04	39	53
P 7311	21	76	W 14054	33	55	83.08.01	39	54
P 7322	21	75	W 14055	31	45	83.110	39	51
P 7323	21	76	W 15055	27	82	83.111	39	52
P 7327	27	68	W 20042	23		10 70 508	31	24
P 7328	27	76	W 20042	29		10 90 110	19	17
P 7329	27	76	W 20043	21	48	10 90 122	33	65
P 7330	27	75	W 20043	25	48	10 90 153	33	68
P 7331	27	75	W 20054	35	136	10 90 153	33	70
P 7362	21	47	W 20127	23	81	10 91 127	33	48
P 7363	23		W 20127	27	78	10 91 127	33	72
P 7371	37	154	10.01.00	39	11	10 92 139	33	46
P 7372	37	155	10.10.00	39	1	9301 224	19	3
P 7383	21	77	10.11.00	39	1	9301 274	19	9
P 7384	21	77	10.22.11	39	5	920 00 926	19	36
P 7387	37	168	10.48.00	39	14	930 05 076	19	37
P 7388	37	169	10.49.00	39	18	930 06 107	33	64
P 7418	31	36	61.02.00	39	4			
P 7419	35	126	61.03.01	37	160			
P 7458	23		61.04.01	39	15			
W 10009	21	59	61.05.00	37	159			
W 10019	25	17	62.02.00	39	12			
W 10020	31	17	63.22.01	39	13			
W 10020	33	81	65.01.00	39	3			
10030	31	22	66.01.00	39	2			
11021	35	134	75.06.15	39	16			

74 07 26 Engelsk

Asbjørnsen 1844